

SHILOH

DISTRIBUTION CENTER



SHILOH ROAD | GARLAND, TEXAS



DEVELOPED BY:

HUNTINGTON
INDUSTRIAL PARTNERS



HOLT LUNSFORD
COMMERCIAL

FOR LEASING/SALES INFORMATION:

Josh Barnes, SIOR
972.280.8353
jbarnes@hldallas.com

SHILOH

DISTRIBUTION CENTER

SHILOH

DISTRIBUTION CENTER

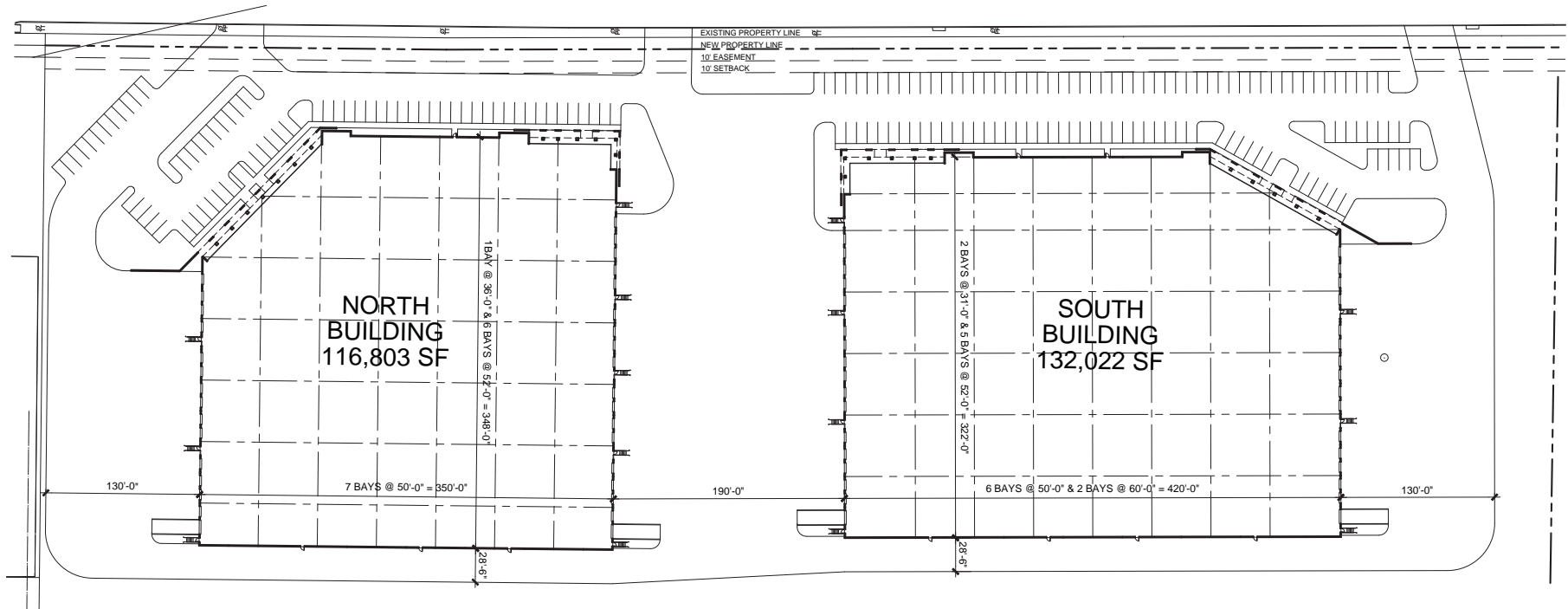

Building Configuration: Cross Dock

Building Size: North Building: 116,803 SF
South Building: 132,022 SF
(DIVISIBLE)

Office: Build To Suit

Acres: 16.22 Acres

Clear Height: 32'

Parking: North Building: 70
South Building: 113

Building Depth: North Building: 350'
South Building: 420'

Loading: North Building: 31 Dock High
South Building: 33 Dock High

Truck Court Depth: 130', 190' shared truck court

Fire Sprinklers: ESFR

Column Spacing: 50' x 52' (typical),
60' loading bays on
South building

Lighting: Build to Suit

Power: Build to Suit

DEVELOPED BY:



FOR LEASING/SALES INFORMATION:



HOLT LUNSFORD
COMMERCIAL

Josh Barnes, SIOR
972.280.8353
jbarnes@hldallas.com

SHILOH

DISTRIBUTION CENTER

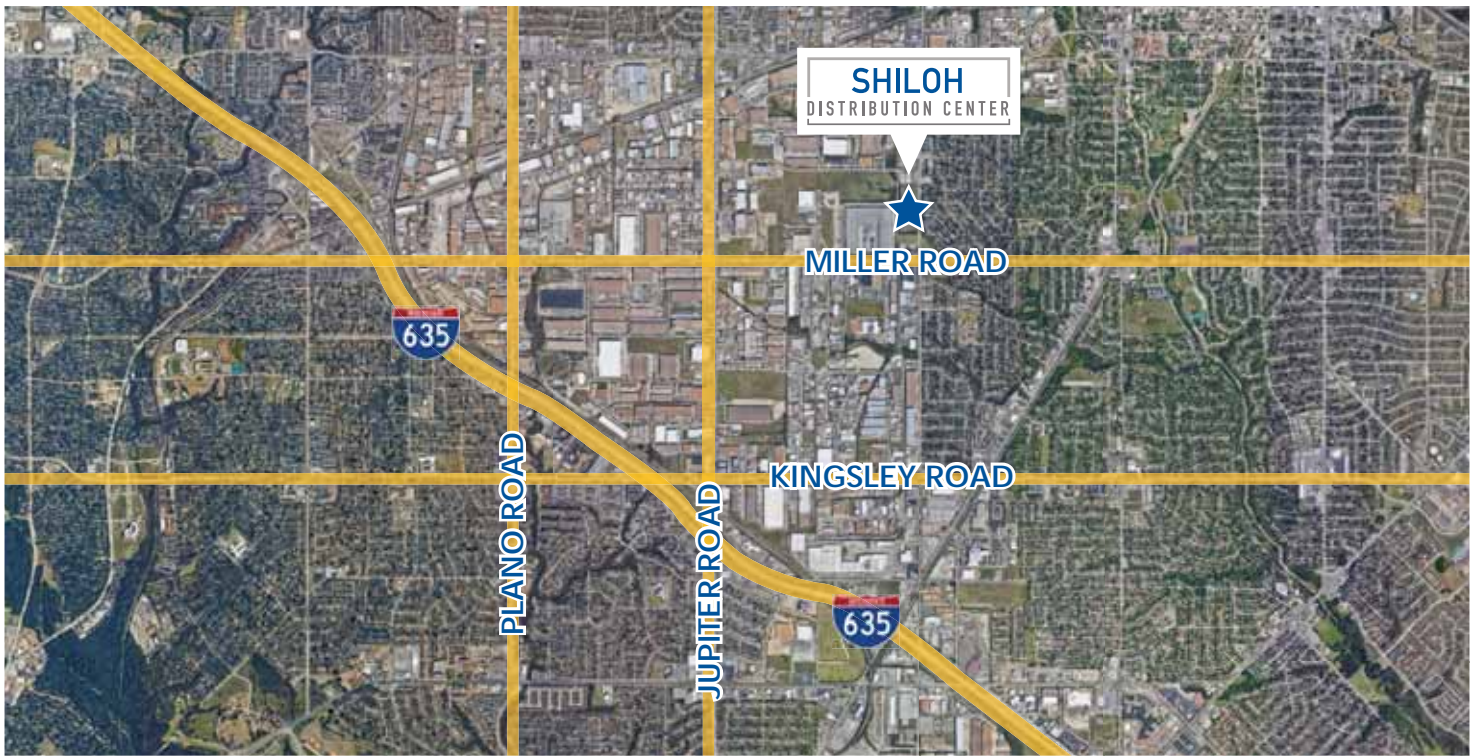

LOCATION HIGHLIGHTS

- Triple Freeport Tax Incentive
- Excellent access to labor – Garland ranked as sixth hardest working city in America by Forbes in 2015
- City of Garland was ranked the eighth best run city in America by WalletHub in 2015
- Easy access to I-635, I-30 and US-75
- Nearby railway intermodals: Union Pacific and Kansas City Intermodal

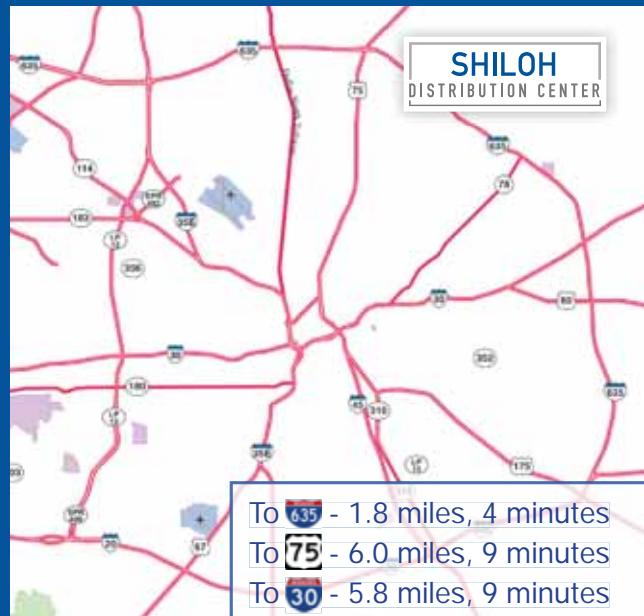

DEVELOPED BY:



FOR LEASING/SALES INFORMATION:



Josh Barnes, SIOR
972.280.8353
jbarnes@hldallas.com